

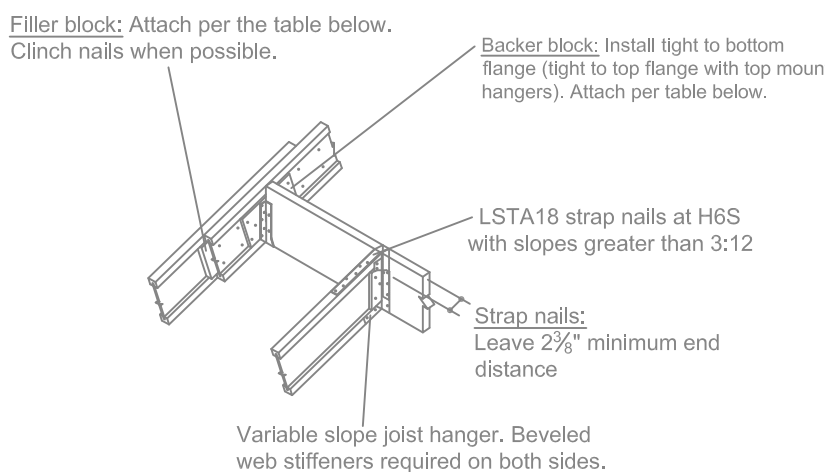

ROOF DETAILS

General Notes
Unless otherwise noted, all details are valid to a maximum slope of 12:12. Joists >16" have a maximum slope of 3:12.

Web stiffeners are required with all 22" and 24" joists and when the sides of the hanger do not laterally support at least 3/4" of the TJI® joist top flange. Also see framing plan.

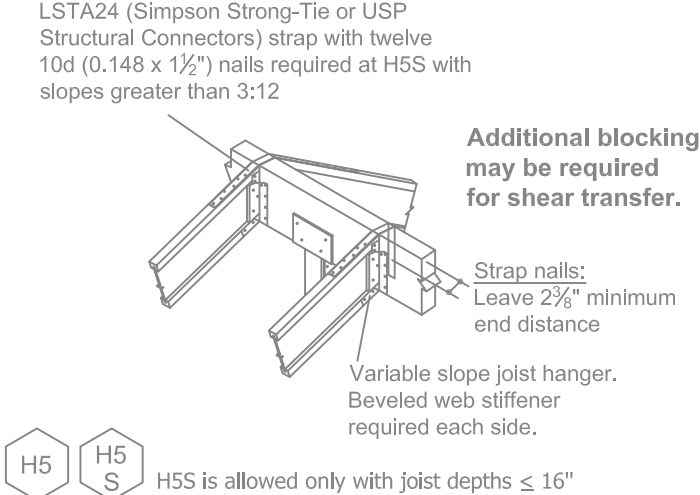
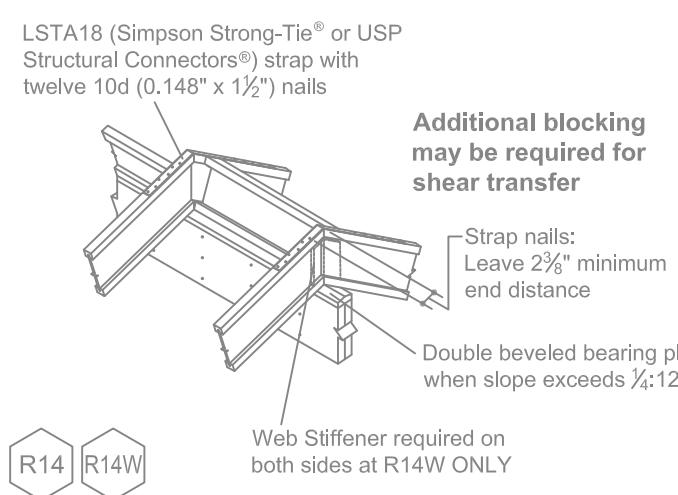
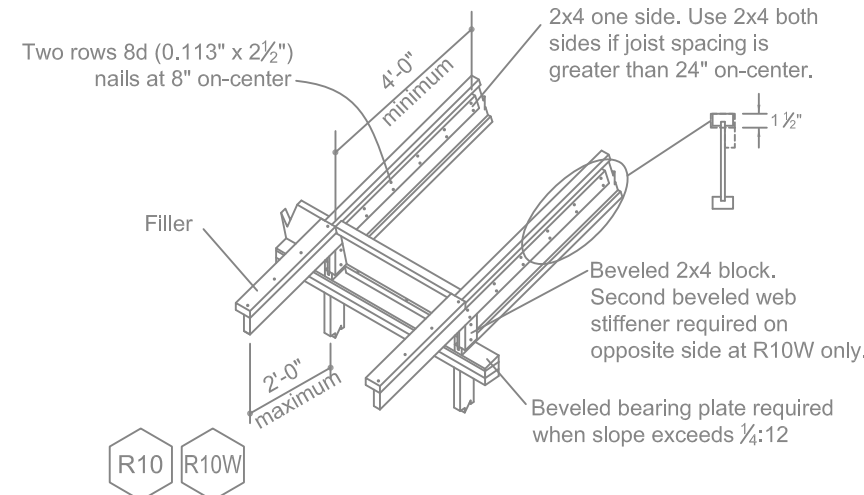
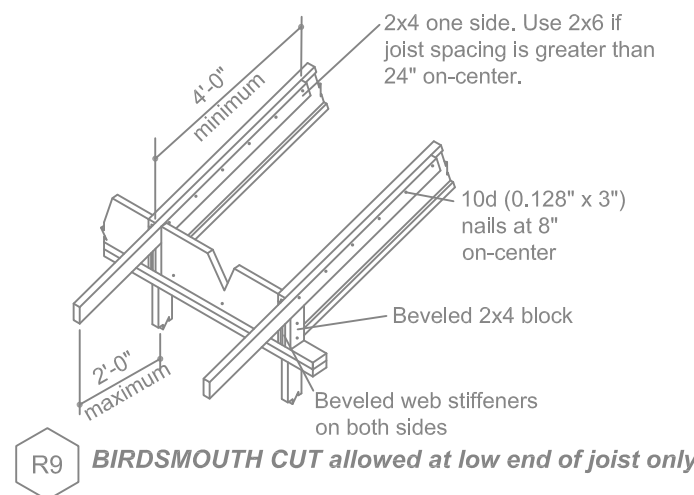
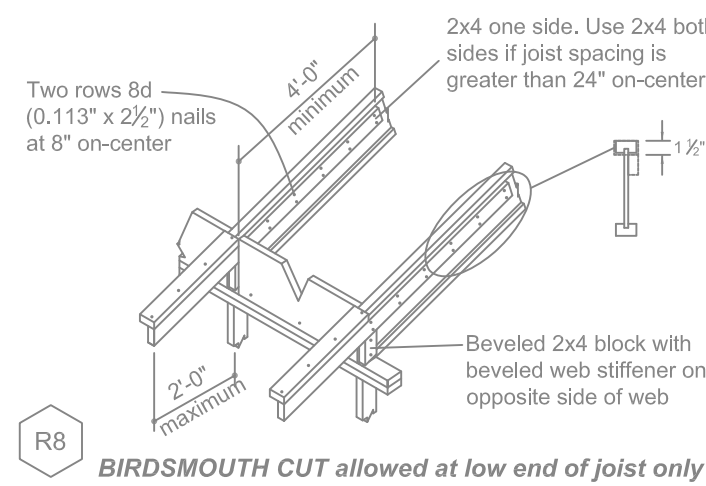
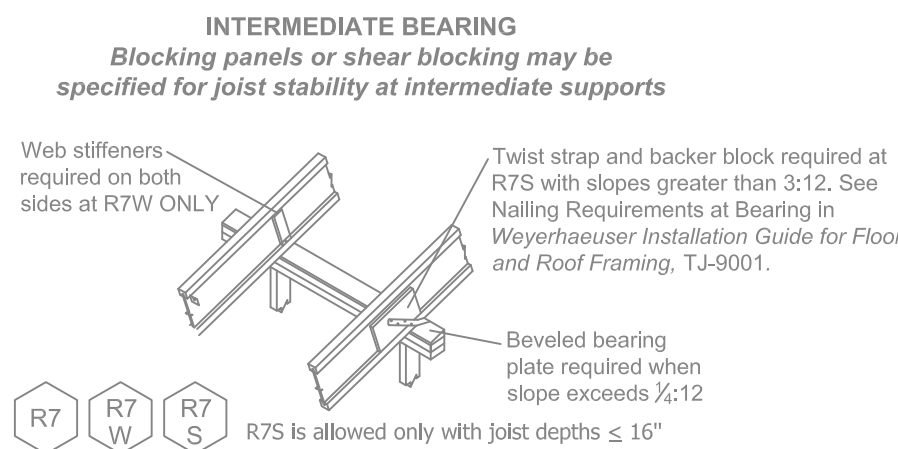
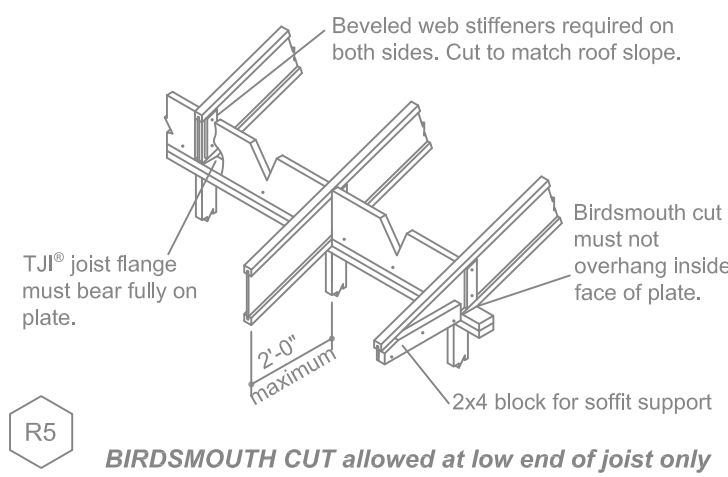
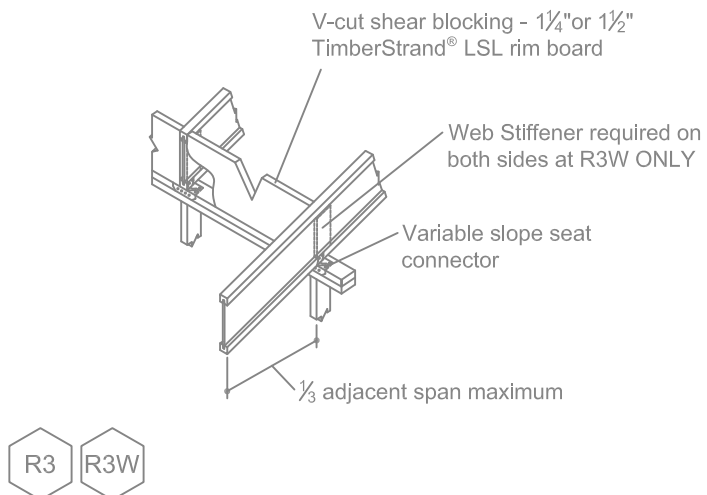
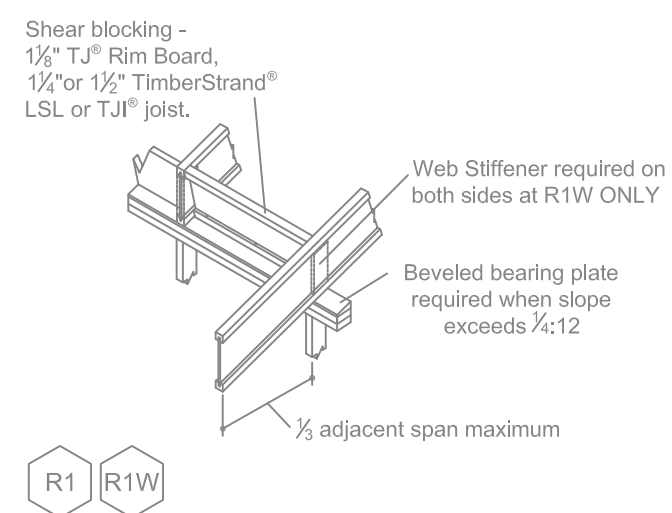

TJI® Depth, D	TJI® Flange Width	Block Type	Nail	
			Size	Quantity
9 1/2" < D ≤ 16"	less than 3 1/2"	Filler	10d(0.128" x 3")	10
		Backer	10d(0.128" x 3")	10
16" < D ≤ 20"	3 1/2"	Filler	16d(0.135" x 3 1/2")	10 - each side
		Backer	10d(0.128" x 3")	10
20" < D ≤ 24"	less than 3 1/2"	Filler	10d(0.128" x 3")	15
		Backer	10d(0.128" x 3")	15
	3 1/2"	Filler	16d(0.135" x 3 1/2")	15 - each side
		Backer	10d(0.128" x 3")	15

H6S is allowed only with joist depths ≤ 16"
For filler and backer block sizes see **Weyerhaeuser TJI® Joist Specifier's Guide, TJ-4000**

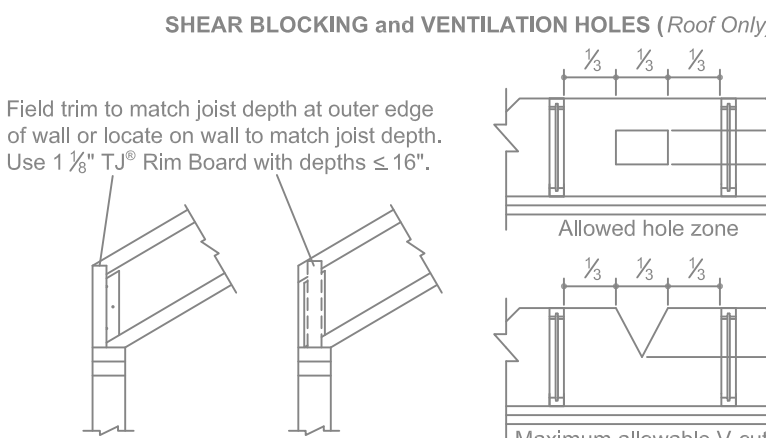

For TJI® joists with slopes of 10:12 to 12:12, the vertical depth of shear blocking at bearing will require 1 1/2" TJI® Rim Board or 1 1/2" or 1 1/2" TimberStrand® LSL that is one size deeper than the TJI® joist. DO NOT use 1 1/2" TJI® Rim Board with 18"-24" TJI® joists or in ventilation - hole applications.

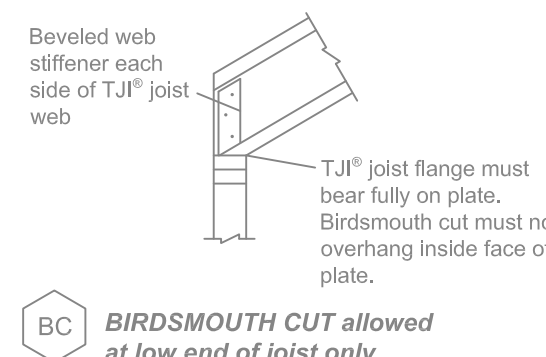
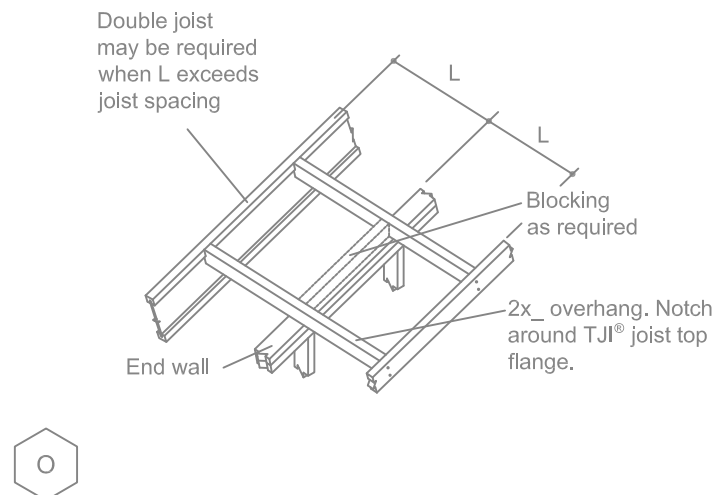

ROOF FRAMING DETAILS

Heel Connection (Platform)

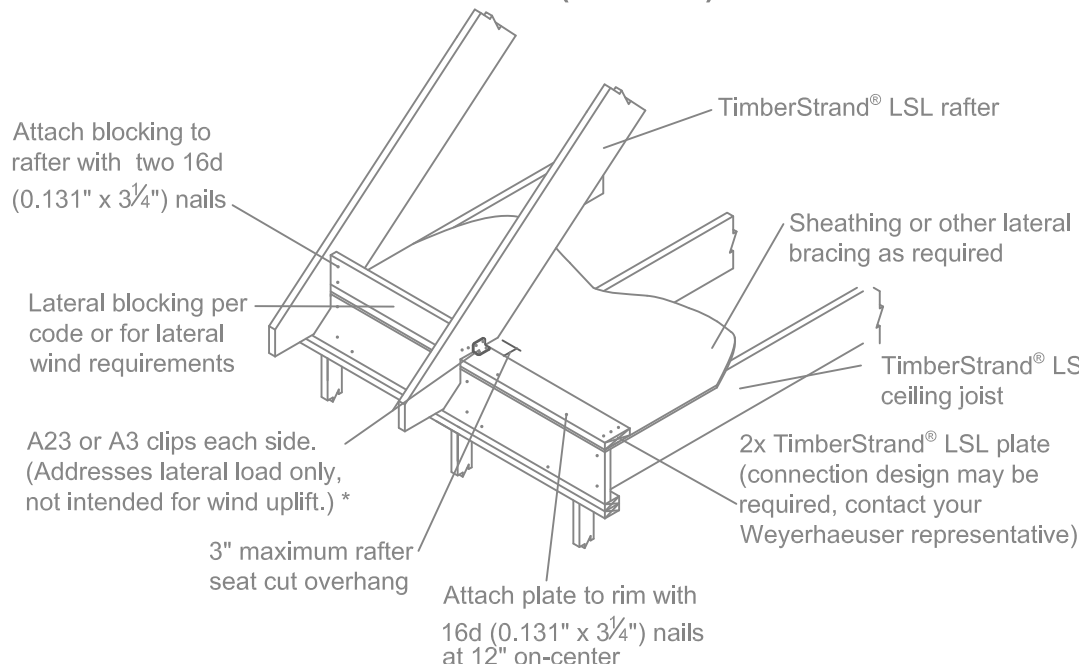

* Angle Clips	Hanger Type	Clip	Nailing	
			Top Plate	Rafter/Ceiling Joist
Simpson Strong Tie®	A23	10d x 1 1/2"	10d x 1 1/2"	10d x 1 1/2"
			10d x 1 1/2"	10d x 1 1/2"
USP Structural Connectors®	A3	10d x 1 1/2"	10d x 1 1/2"	10d x 1 1/2"
			10d x 1 1/2"	10d x 1 1/2"

Rafter Connection for Thrust:
• For lap connection nail quantity requirements, see Rafter Span and Heel Connection Tables in *Weyerhaeuser Roof System Design Guide*, TJ-9005.
• If fewer than 8 nails are required, use only one A23 or A3 clip, each side.
• If 8-15 nails required, use two A23 or A3 clips, each side.

Outlooker Detail

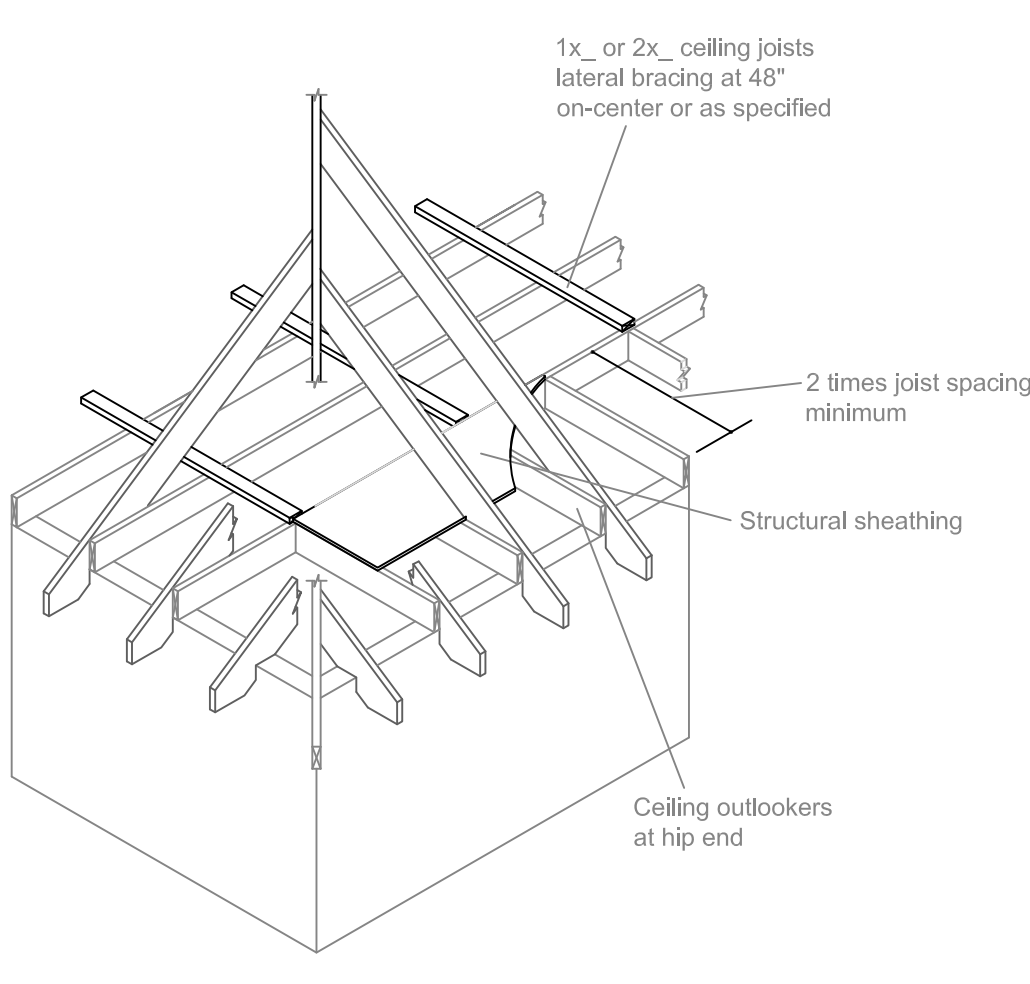

Hip/Valley Intermediate Support

Connect rafter to hip with five 16d (0.131" x 3 1/4") nails.
Connect rafter to valley with 16d (0.131" x 3 1/4") nails per table below.

Rafter On-Center Spacing	Rafter Span	Roof Snow Load			
		30 LL + 15 DL	50 LL + 15 DL	80 LL + 15 DL	Number of 16d (0.131" x 3 1/4") nails required
16"	6'	5	5	5	
	12'	5	6	8	
	18'	6	9	12	
	24'	8	12	*	
24"	6'	5	5	7	
	12'	6	8	11	
	18'	9	13	*	
	24'	12	*	*	

* Contact your Weyerhaeuser representative for additional connection information.

Dormer Framing

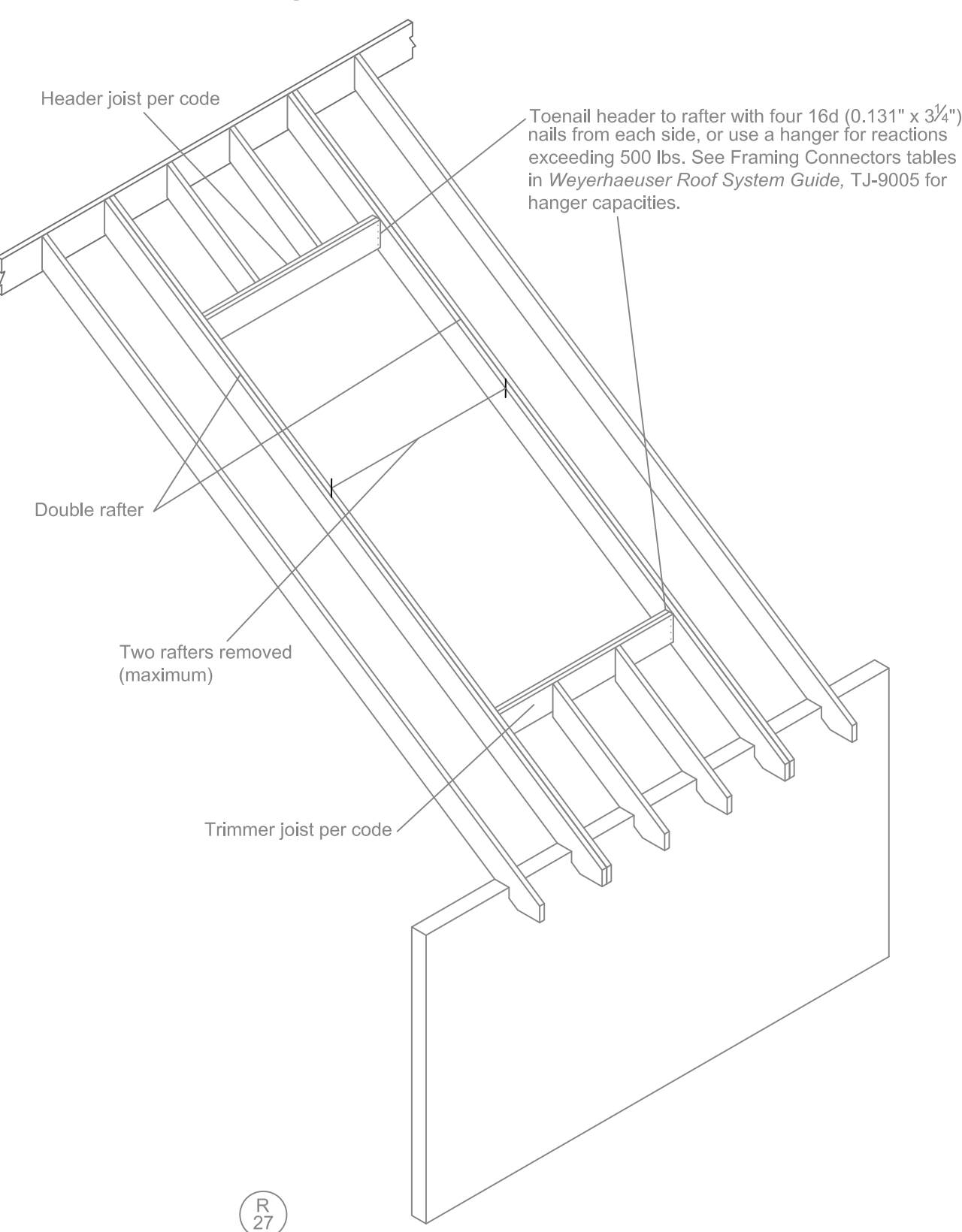

R 27

Ridge Connection

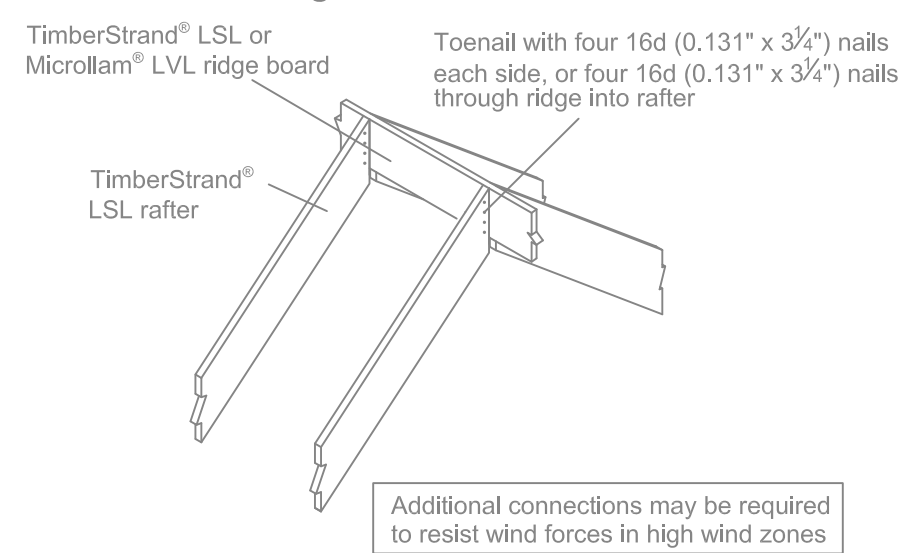

Rafter Size	Rafter Pitch		
	4:12 to 9:12	10:12 to 11:12	12:12
Ridge Board Sizes			
2x6	2x8	2x10	2x10
2x8	2x10	2x12	2x12
2x10	14"	14"	14"
2x12	14"	16"	16"

Heel Connection (Lap)

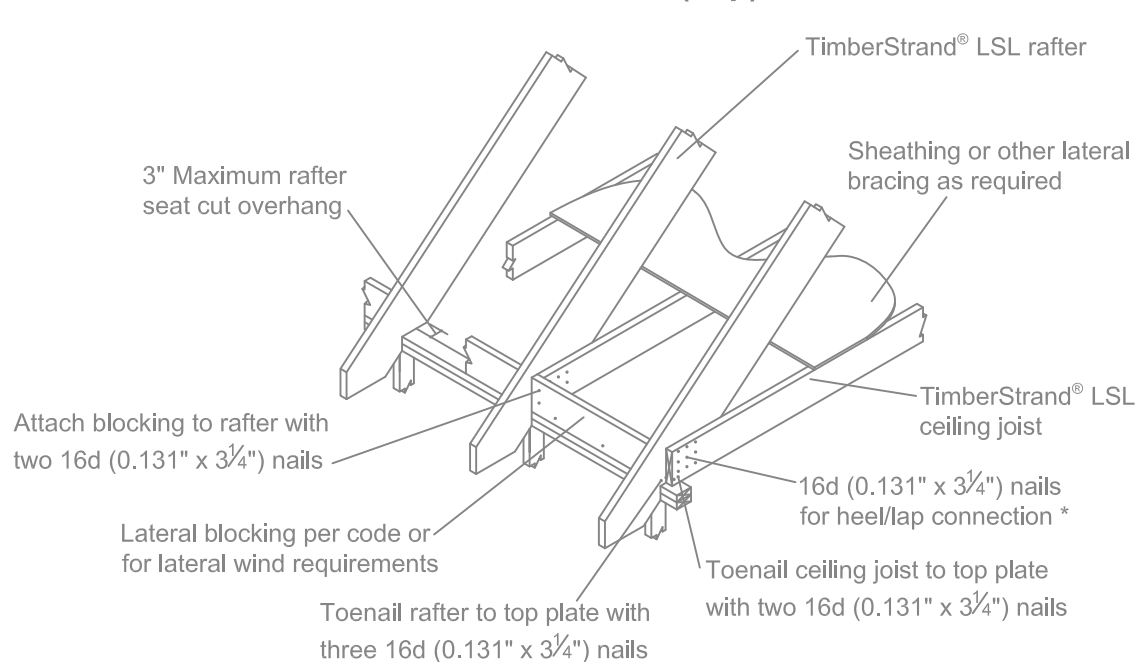

Hip/Ridge/Valley/ Post Detail

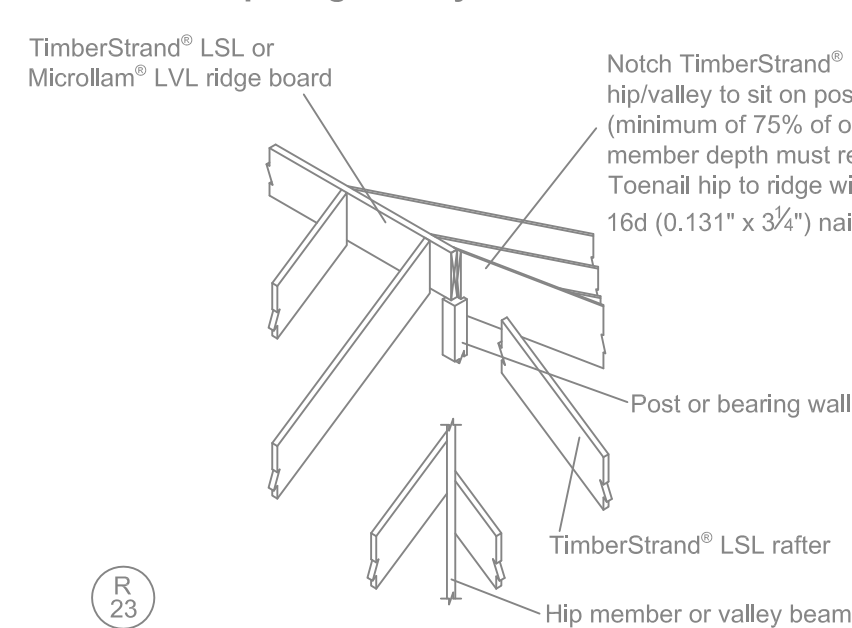

Hip/Valley Low End

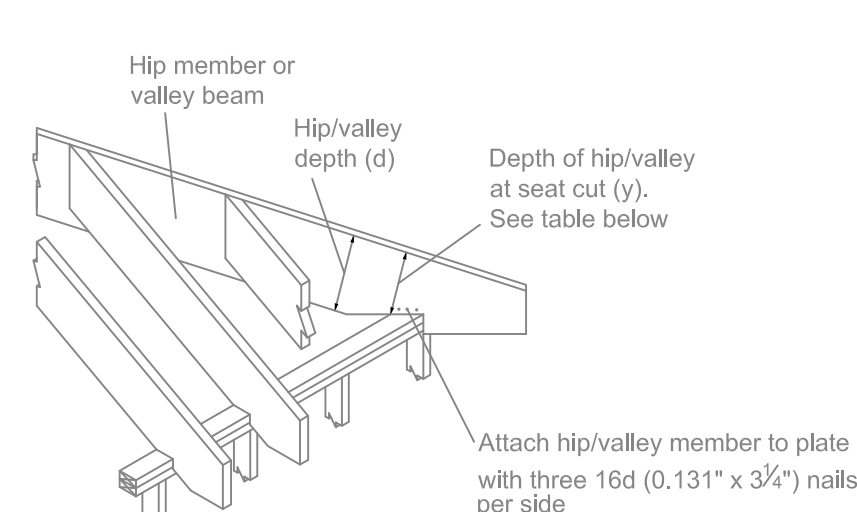

Hip/Valley Depth	
Minimum Percentage of Original Hip/Valley Depth Required	
Member Type	TimberStrand® LSL
Hip Member	30%
Valley Beam	80%
Calculate percentage as 90 x 100	

Valley -to- Hip Connection

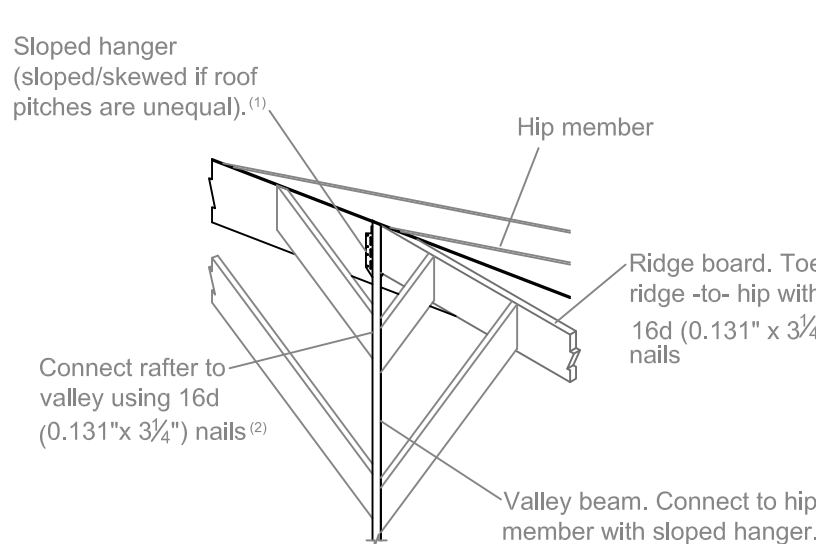

Contact your Weyerhaeuser representative for sizing of a hip or valley with a point load.
(1) See Framing Connectors in *Weyerhaeuser Roof System Guide*, TJ-9005 for hanger capacities.
(2) See Rafter -to- Valley Connection table in Detail R26 above.



Weyerhaeuser, Microlam, Parallam, TimberStrand, TJI, TJ, and Trus Joist are registered trademarks of Weyerhaeuser NR. © 2014 Weyerhaeuser NR Company. All rights reserved.

Warning: Drilling, sawing, sanding or machining wood products generates wood dust. The paint and/or coating on this product may contain titanium dioxide. Wood dust and titanium dioxide are substances known to the state of California to cause cancer. For more information on Proposition 65, visit [wy.com/inform](http://www.wy.com/inform).

October 2017 Reorder TJ-4014



1-888-453-8358
woodbywy.com

COMMENT

REV BY DATE

PROJECT #:

SERVICE #:

SHEET
_ of _