

GYPSUM BOARD APPLICATION TO I-JOIST — DETAIL

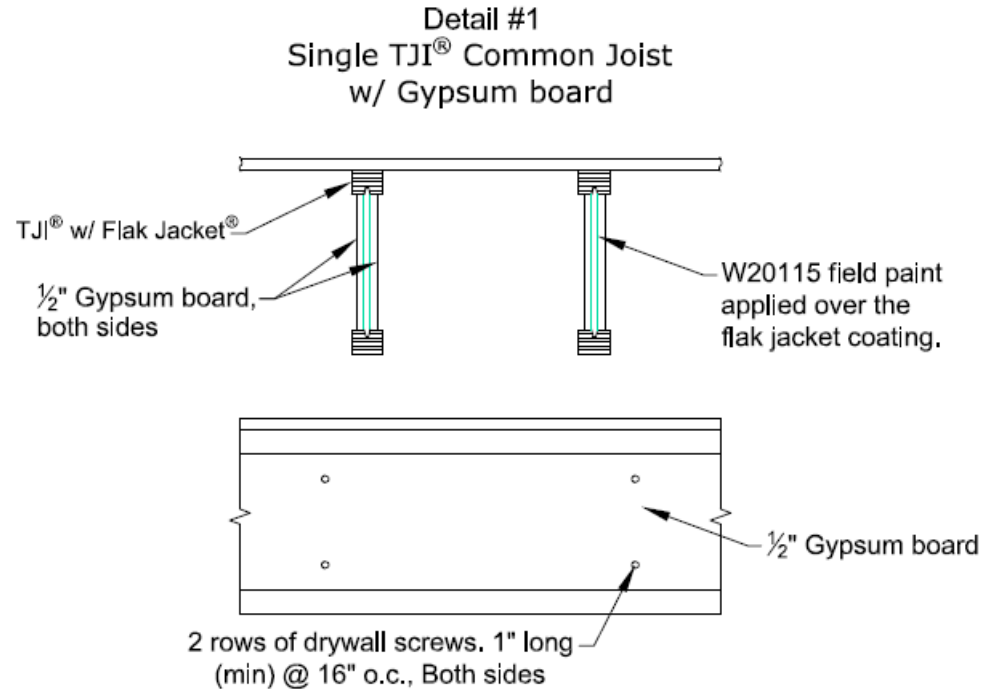

Note:

- Only required when excessive de-bonding of Flak Jacket coating exists.
- Apply W20115 field paint in accordance with the Scope of Work Document over the Flak jacket Coating. Attach 1/2" gypsum board over the joist web after field paint is dry.



PROJECT	Single TJI® Common Joist w/ Gypsum board	DATE	8-28-17
		SCALE	NTS
Weyerhaeuser Corporate Headquarters			
220 Occidental Avenue South, Seattle, WA 98104			
1-800-525-5440			