

## RESILIENT CHANNEL & CEILING MEMBRANE ATTACHMENT GUIDE FOR 1-1/8" EDGE GOLD<sup>™</sup> SOUND ASSEMBLY

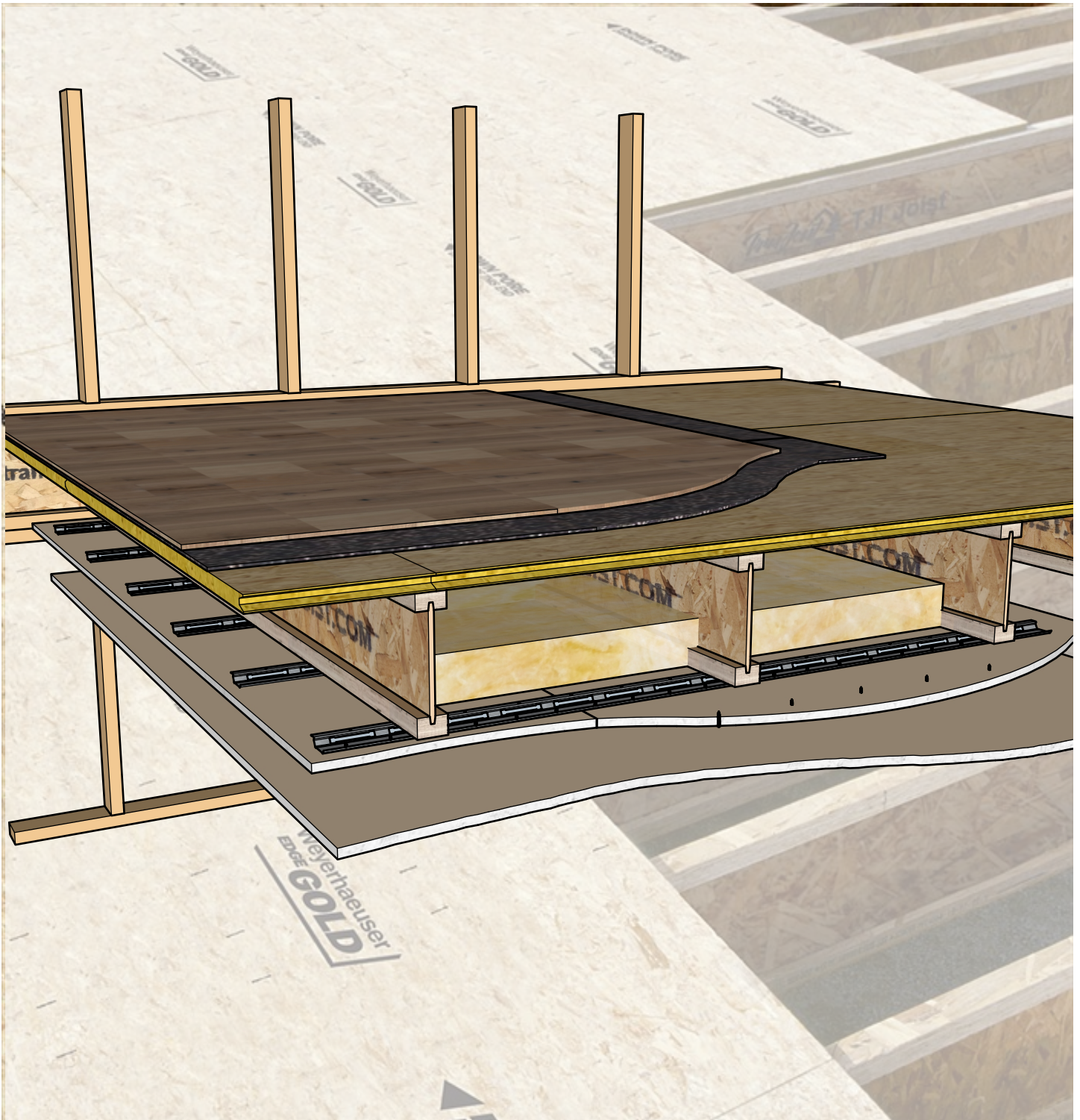

# 1-1/8" EDGE GOLD™ SOUND ASSEMBLY

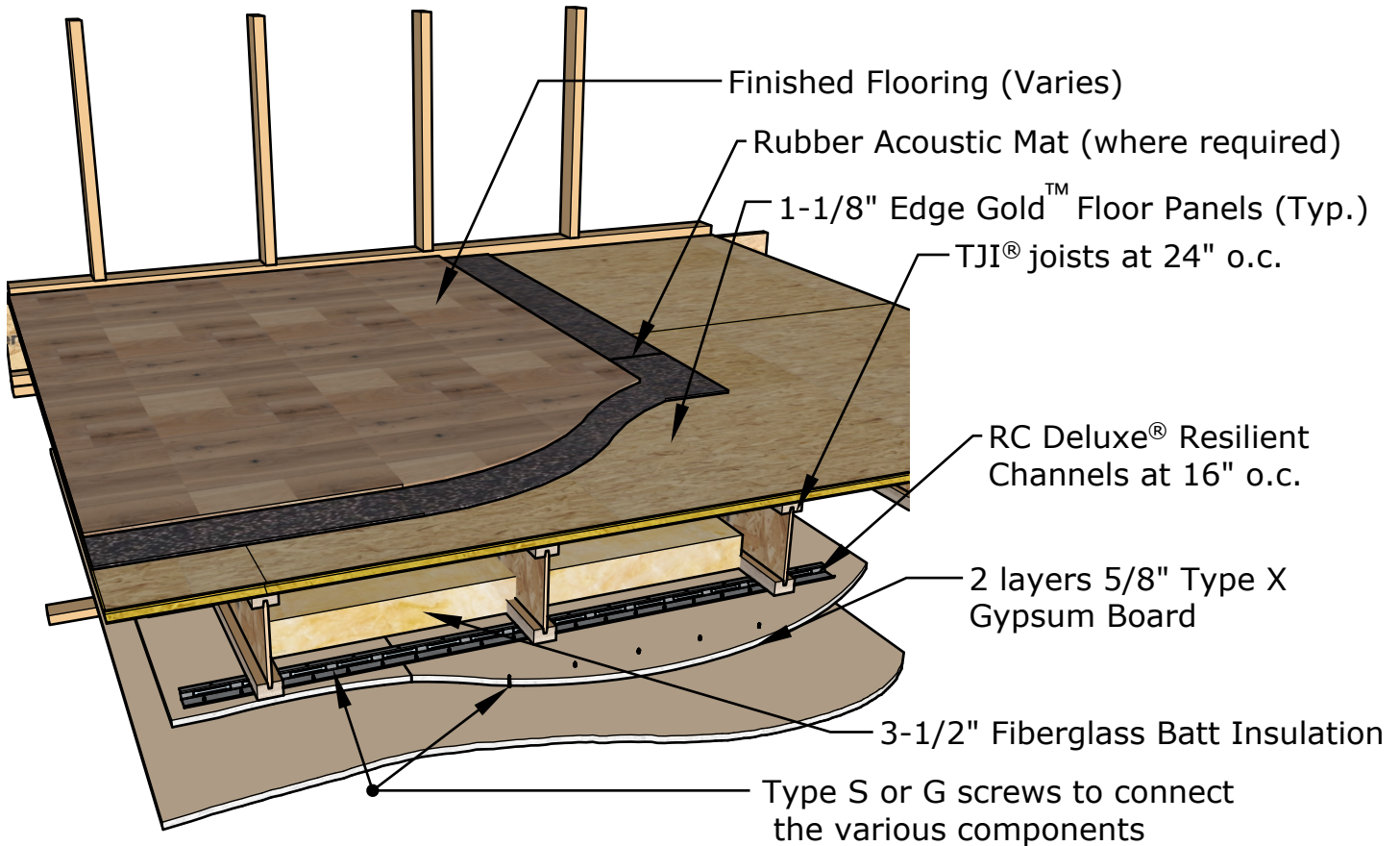

## Material required for this assembly

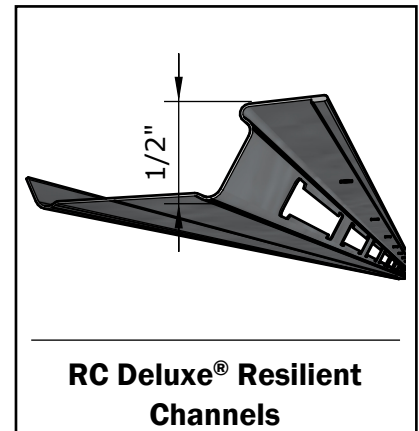
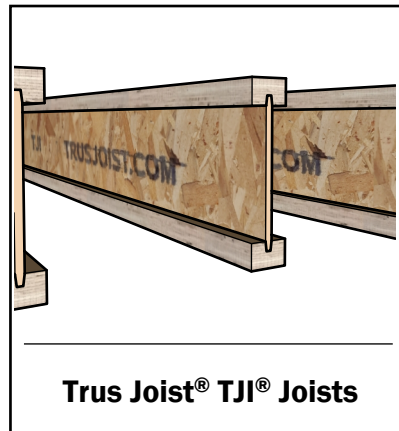
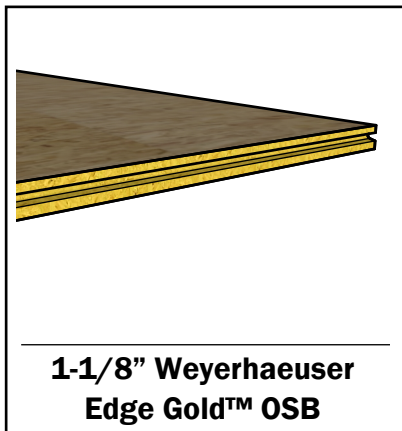

- Subfloor Adhesive
- Nails
- 5/8" Type X Gypsum Board
- 3 1/2" Fiberglass Batt Insulation
- Rubber Acoustic Mat (where required)
- Finished flooring

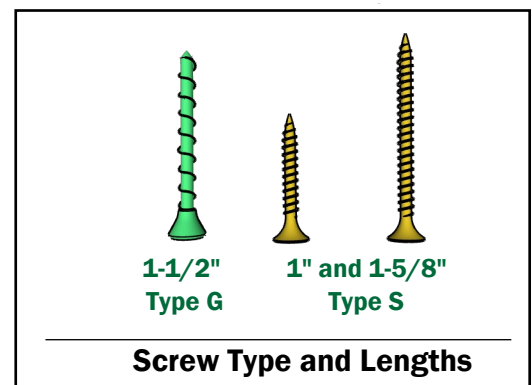

**Modifications to the assembly, including the substitution of materials or product spacing changes, may affect floor and sound performance.**



TJI® JOISTS AND 1-1/8" EDGE GOLD™ FLOOR PANELS



Install TJI® Joists and 1-1/8" Edge Gold™ Floor Panels.  
Refer to installation resources TJ-9030, TJ-9001 and OSB-4004 (QR Codes shown below)



TJ-9030

# FLOOR

## FRAMING STANDARDS

A Framers Guide to the INSTALLATION PROCESS



WEYERHAEUSER.COM/WOODPRODUCTS

1.888.453.8358

 Weyerhaeuser



Scan QR Code above  
for TJ-9030



1.888.453.8358 | weyerhaeuser.com/woodproducts

### INSTALLATION GUIDE

#### FOR FLOOR AND ROOF FRAMING



**WARNING:**  
DO NOT work on joists with flames. **HEAVY RAIN RESULTS.**



**WARNING:**  
DO NOT walk on joists that are **spring fast.**



**WARNING:**  
DO NOT stack building materials on unfastened joists, stacks and over beams or walls.

IMPORTANT: PLEASE READ CAREFULLY!

TJ-9001



Scan QR Code above  
for TJ-9001

Weyerhaeuser™  
**EDGE GOLD**  
OSB-4004



Scan QR Code above  
for OSB-4004

# RC DELUXE® RESILIENT CHANNELS

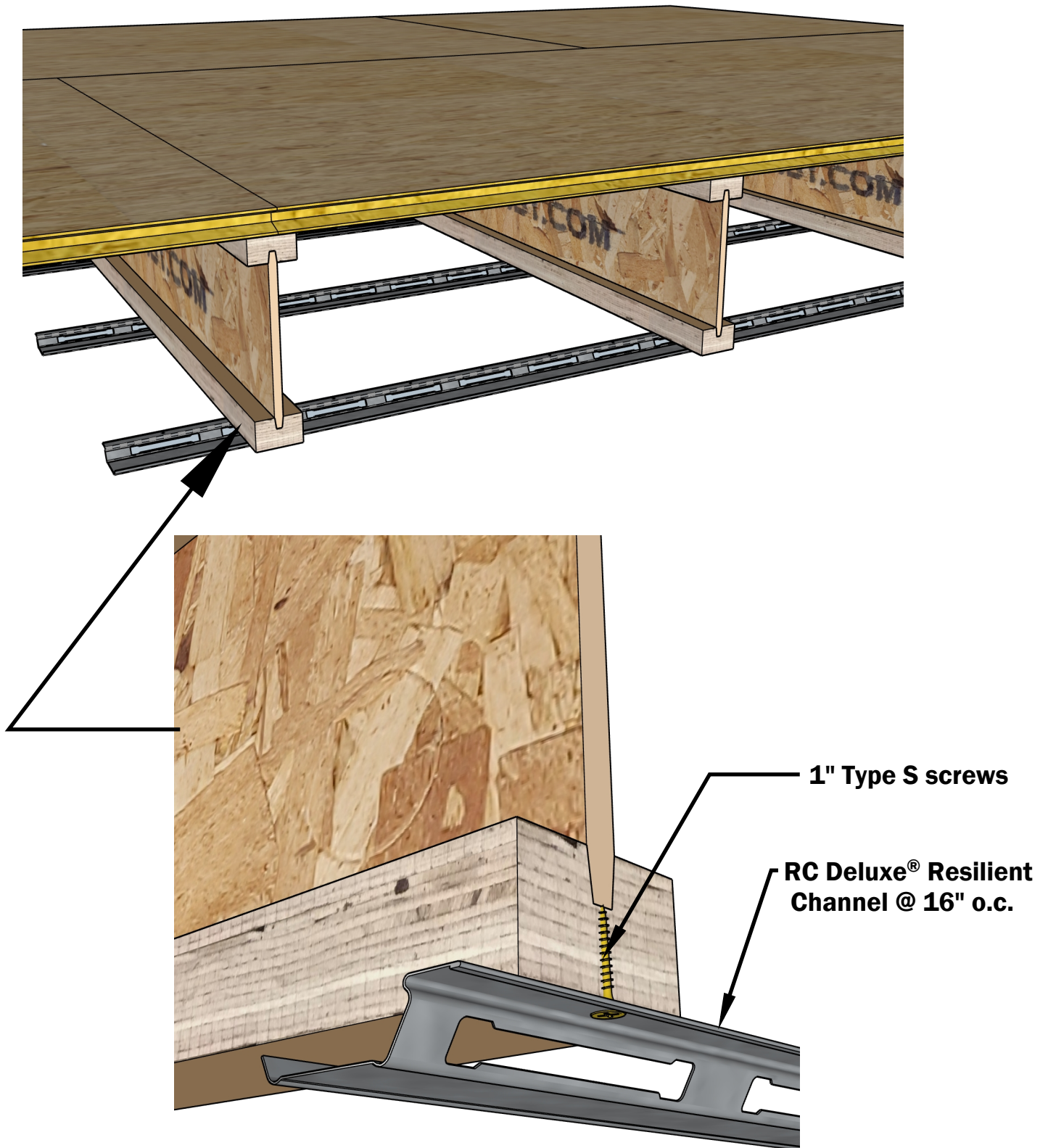

**Install RC Deluxe® Resilient Channel at 16" o.c. with 1" Type S screws**



## 1<sup>ST</sup> LAYER 5/8" TYPE X GYPSUM BOARD

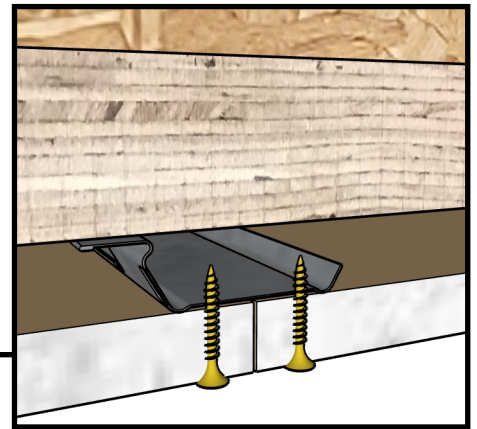
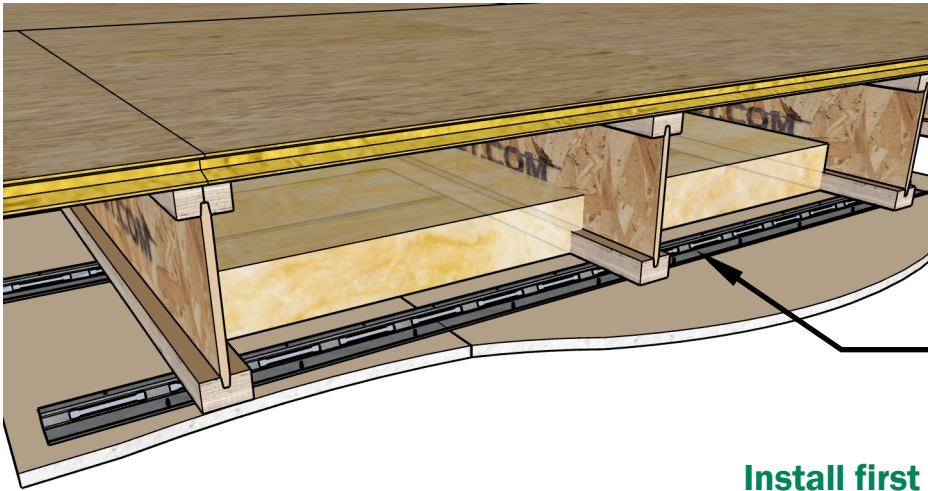

Install first layer of 5/8" Type X Gypsum Board with 1" Type S screws at 12" o.c.

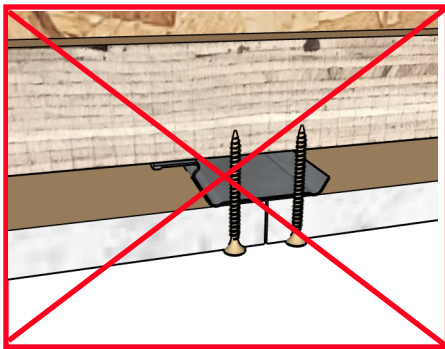

### DO NOT ATTACH GYPSUM BOARD TO TJI<sup>®</sup> JOIST

Ensure screws only connect the 5/8" Gypsum Board to the resilient channel. An air gap is required between screws and TJI<sup>®</sup> Joist flanges.

## 2<sup>ND</sup> LAYER 5/8" TYPE X GYPSUM BOARD

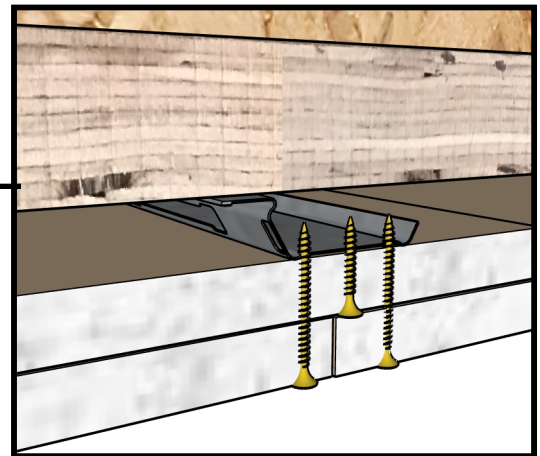
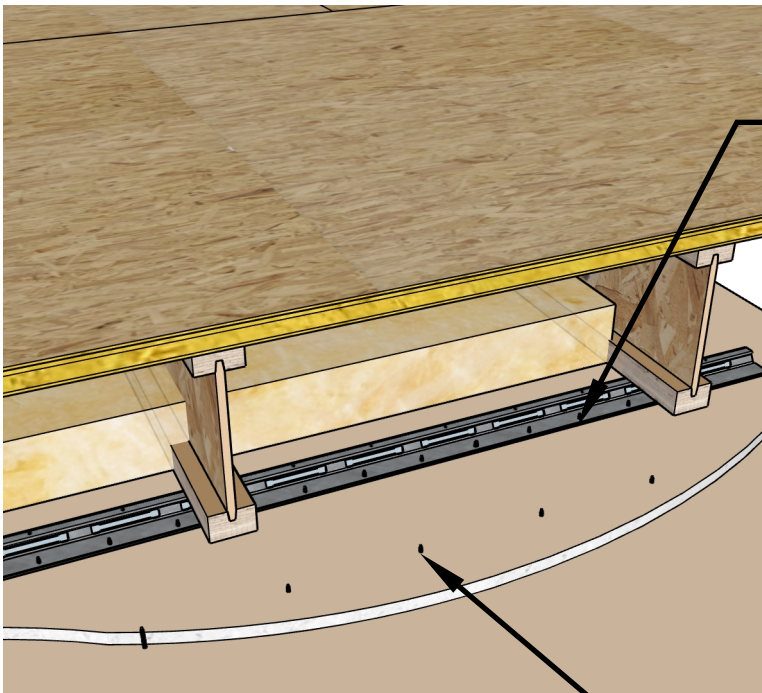

Install second layer of 5/8" Type X Gypsum Board with joints staggered from the first layer and attached using 1-5/8" Type S screws at 12" o.c. in the field & 8" o.c. at butt joints.

1-1/2" Type G screws, must be spaced 8" o.c. and 6" from each side of traverse joints on the second layer. The second layer must be finished with joint tape and compound.



*This step requires two distinct screw types. Changing screw type or spacing may impact floor sound performance.*

# CAVITY INSULATION AND FLOORING COMPONENTS

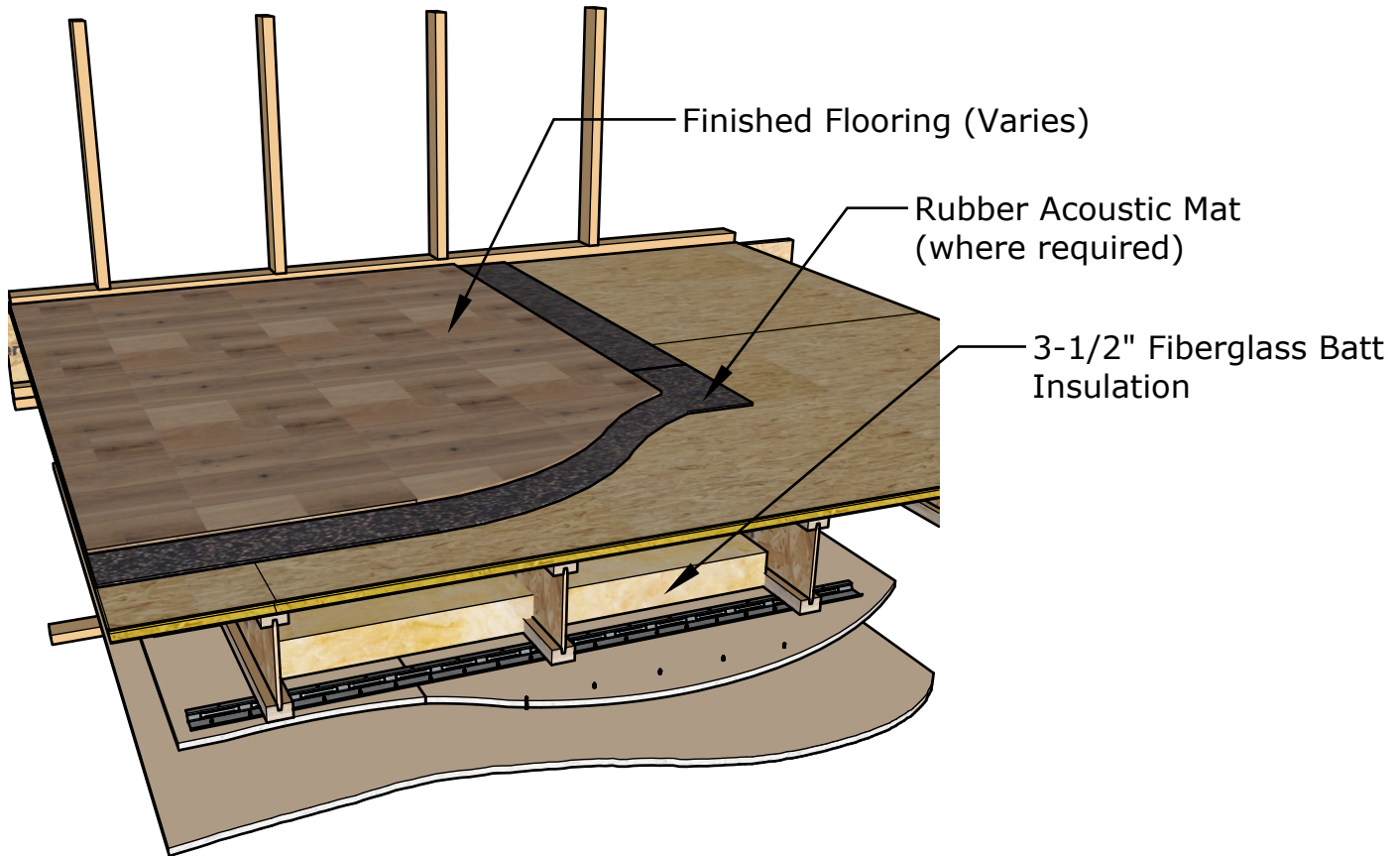

**Install Cavity Insulation and Flooring components,  
refer to page 2 of TJ-4035 for details.  
(QR Code shown below)**

1 1/2" OSB (WITH RUBBER ACOUSTIC MAT WHERE REQUIRED)

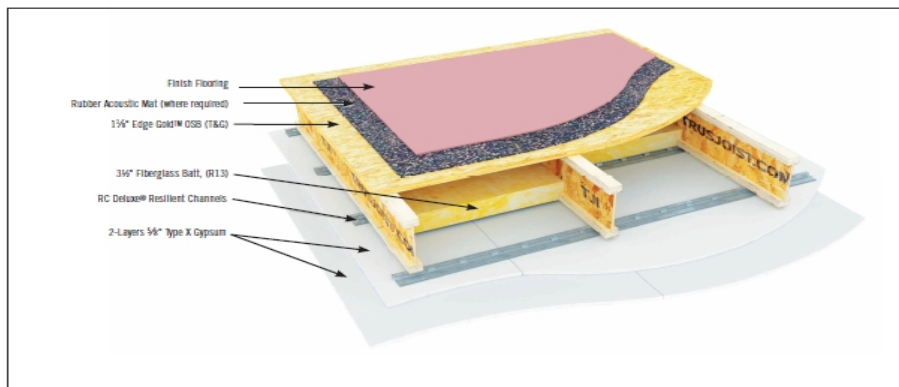

Scan QR Code above  
for TJ-4035

FLOOR FINISHING	SINGLE-LAYER CEILING			TWO-LAYER CEILING		
	STC	IIC	Reports	STC	IIC	Reports
Bare OSB	--	--	--	55	44	A1-020802.2
Ceramic Tile adhered to Sonus Core 3 with Thinset Mortar	--	--	--	64	51	A1-020802.6
Quarry Tile Adhered to ECOsilence 5 with Thinset Mortar	--	--	--	--	52	NGC7015194
8.5 mm, 1.2 psf LVP with Cork Back Floating Over Sonus Core 3	--	--	--	62	53	A1-020802.4
5 mm, 2.2 psf LVT Floating Over ECOsilence 5	--	--	--	--	51	NGC7015199
3/4\" Engineered Hardwood Floating Over Sonus Core 3	--	--	--	62	52	A1-020802.1
3/4\" Engineered Hardwood Floating Over ECOsilence 5	--	--	--	--	53	NGC7015200
0.08\", 0.56 psf Cushioned Vinyl	--	--	--	57	50	A1-020002.5
0.145\", 0.53 psf Cushioned Vinyl <sup>(1)</sup>	--	--	--	--	51	NGC7016095
Carpet and Pad	--	--	--	--	69	NGC7015197

(1) Requires minimum 3\" (2.8 psf) mineral wool batt instead of R13 fiberglass batt.